

SIMPLE BUFFERS

AMC

MECANOCAUCHO®

TYPE D

APPLICATIONS

As BUFFERS: In any case for limiting a flexible element.

- End of stroke of spring or damper.
- End of stroke of cranes and hoists.
- Setting of fragile material in packings.

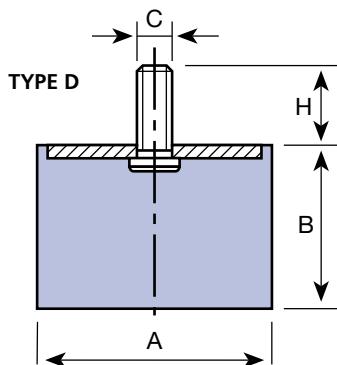
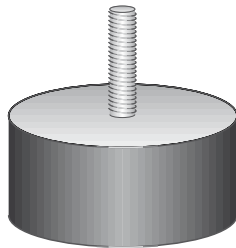

A	B	C	H	COMPRESSION		CODE
				LOAD max. daN	DEFLECT. m m.	
12,5	10	M-5	10	12	2	110001
	15			10	3	110002
	20			8	3,5	110003
16	10	M-5	12	20	1,5	110004
	15			20	3	110005
	20			15	4	110006
	25			15	5	110007
	25			15	5	110007
20	8,5	M-6	16,5	40	1,5	110008
	15			35	4	110009
	20			30	5	110010
	25			30	5,5	110011
	30			25	7	110012
	30			25	7	110012
25,5	10	M-6	18	80	2	110091
	15			60	3,5	110092
	20			55	4,5	110093
	25			50	6	110094
	30			50	8	110095
	10	M-8	20	80	2	110013
	15			60	3,5	110014
	19			55	4,5	110015
	22			50	5,5	110016
	25			50	6	110017
30	50	8	110018			
40	50	10	110019			
30	15	M-8	20	90	3	110020
	22			80	5	110021
	25			75	6,5	110101
	30			70	8	110022
	40			60	9	110023
40	20	M-8	20	160	5	110112
	25			150	6	110113
	28			150	6	110114
	30			150	6	110115
	35			120	8	110116
	40			120	10	110117
	45			120	11	110118
	45			120	11	110118
40	20	M-10	25	160	5	110024
	25			150	6	110110
	28			150	6	110025
	30			150	6	110111
	35			120	8	110026
	40			120	10	110027
	45			120	11	110028
	45			120	11	110028
50	20	M-10	25	300	5	110121
	25			300	6	110029
	30			275	7	110122
	35			250	8	110030
	40			210	10	110123
	45			190	11	110031
	50			170	11	110124
60	150	11	110032			
60	25	M-10	25	400	6	110033
	36			300	9	110034
	45			250	11	110035
	60			200	12	110036
	60			200	12	110036
70	35	M-10	25	450	8	110037
	50			350	11	110038
	60			300	12	110039
	70			300	14	110040
	70			300	14	110040
75	25	M-12	30	650	7	110041
	40			500	9	110042
	45			500	10	110043
	55			450	11	110044
80	30	M-14	35	950	7	110045
	40			600	9	110046
	50			550	10	110047
	55			550	11	110048
	70			500	13	110049
	75			450	14	110050
95	40	M-16	45	1.200	8	110051
	55			1.000	11	110052
	60			800	12	110053
	75			700	13	110054
	75			700	13	110054
105	50	M-16	45	1.200	9	110055
	75			1.000	13	110056
	100			800	16	110057
120	50	M-16	45	1.500	9	110058
	75			1.200	13	110059
	100			1.000	16	110060
130	50	M-16	45	1.600	9	110062
	75			1.450	13	110063
	100			1.200	16	110064
150	50	M-20	50	1.800	9	110065
	75			1.650	13	110066
	100			1.400	16	110067