

PROGRESSIVE BUFFERS AMC MECANOCAUCHO®

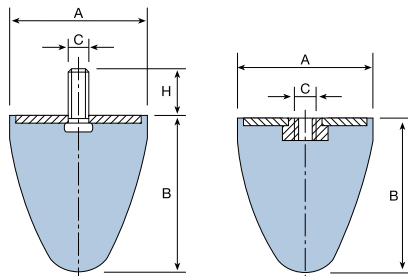

TYPE A

TYPE C

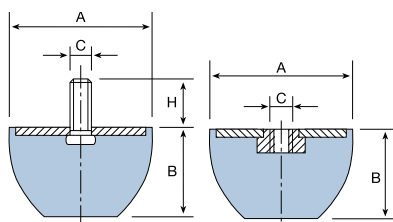

TYPE A

TYPE C

TYPE A	TYPE	A	B	C	H	LOAD Kg.	DYNAMIC DEFLECTION mm.	ENERGY a 1 m/s Kg. m.	CODE
	T-25	25	19	M-8	20	100	8	0.3	115001
T-30	30	30	M-6	16	140	15	0.6	115002	
T-50	50	50	M-8	20	340	25	3	115003	
T-50	50	64	M-8	35	370	32	4	115004	
T-50	50	58	M-8	20	400	28	3.7	115005	
T-70	72	58	M-12	30	550	26	5	115006	
T-95	95	80	M-16	45	1100	37	12	115007	

TYPE C	TYPE	A	B	C	H	LOAD Kg.	DYNAMIC DEFLECTION mm.	ENERGY a 1 m/s Kg. m.	CODE
	T-25	25	19	M-8	20	100	8	0,3	115008
T-30	30	30	M-6	16	140	15	0,6	115009	
T-50	50	50	M-8	20	340	25	3	115010	
T-50	50	64	M-8	35	370	32	4	115011	
T-50	50	58	M-8	20	400	28	3,7	115012	
T-70	72	58	M-12	30	550	26	5	115014	
T-95	95	80	M-16	45	1.100	37	12	115015	

APPLICATIONS

As BUFFERS: In any case for limiting a flexible element.

- End of stroke of spring or damper.
- End of stroke of cranes and hoists.
- Setting of fragile material in packings.

TYPE A	TYPE	A	B	C	H	LOAD Kg.	DYNAMIC DEFLECTION mm.	ENERGY a 1 m/s Kg. m.	CODE
	T-85	84	52	M-12	35	1.500	20	20	116001
T-120	120	75	M-16	45	3.000	22	34	116002	
T-220	220	137	M-24	80	15.000	40	250	116003	

TYPE C	TYPE	A	B	C	H	LOAD Kg.	DYNAMIC DEFLECTION mm.	ENERGY a 1 m/s Kg. m.	CODE
	T-85	84	52	M-12	35	1500	20	20	116011
T-120	120	75	M-16	45	3000	22	34	116012	
T-220	220	137	M-24	80	15000	40	250	116013	

APPLICATIONS

As BUFFERS: In any case for limiting a flexible element.

- End of stroke of spring or damper.
- End of stroke of cranes and hoists.
- Setting of fragile material in packings.